

TESOURA 04
ESCALA 1:50

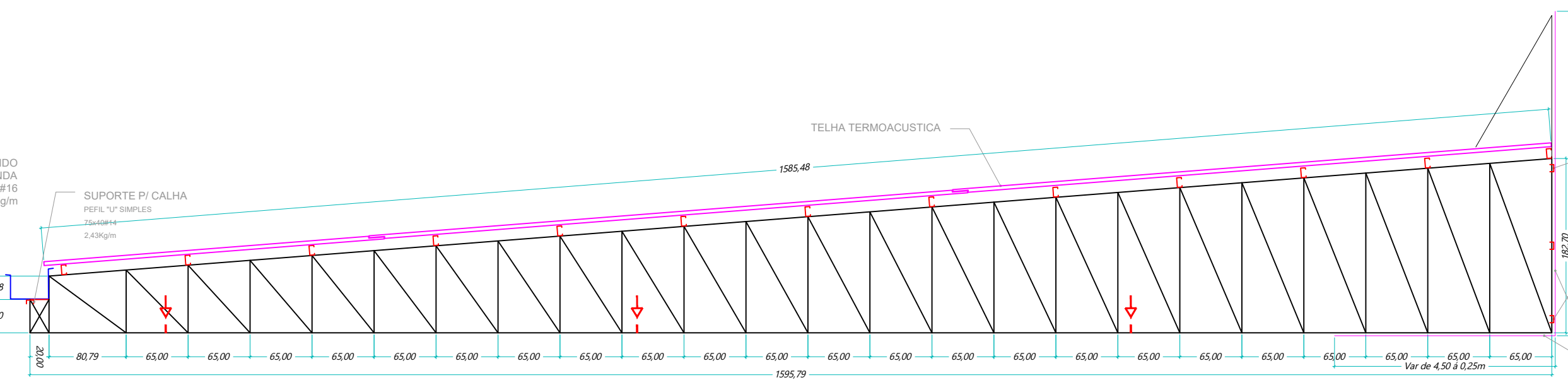

TESOURA 05
ESCALA 1:50

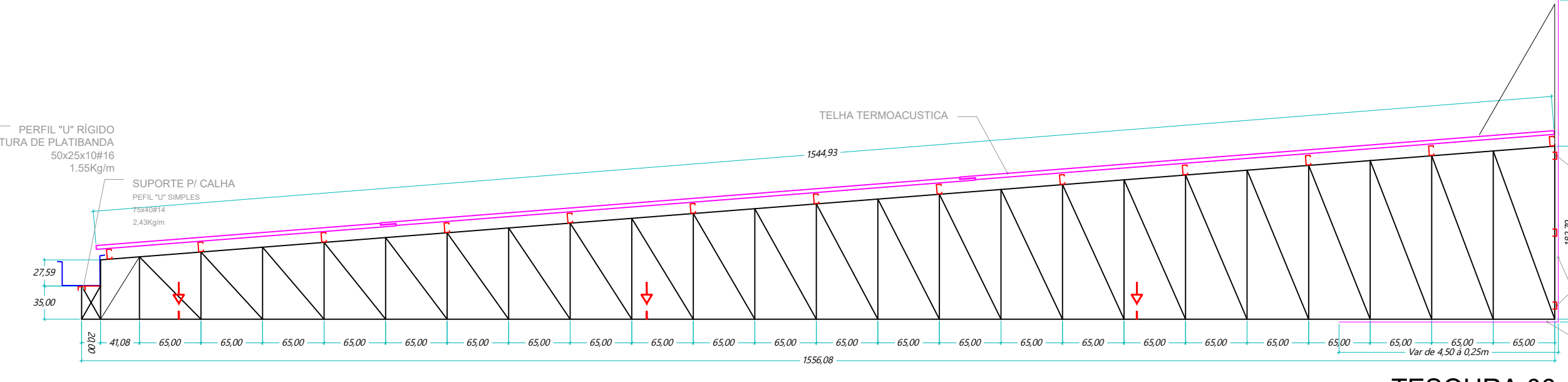

TESOURA 06
ESCALA 1:50

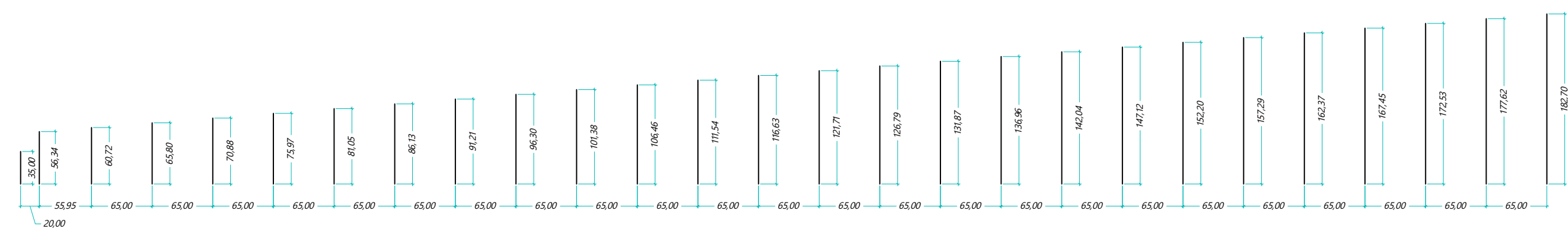

MONTANTE
PERFIL "U" SIMPLIS
127x40#14
3.25Kg/m

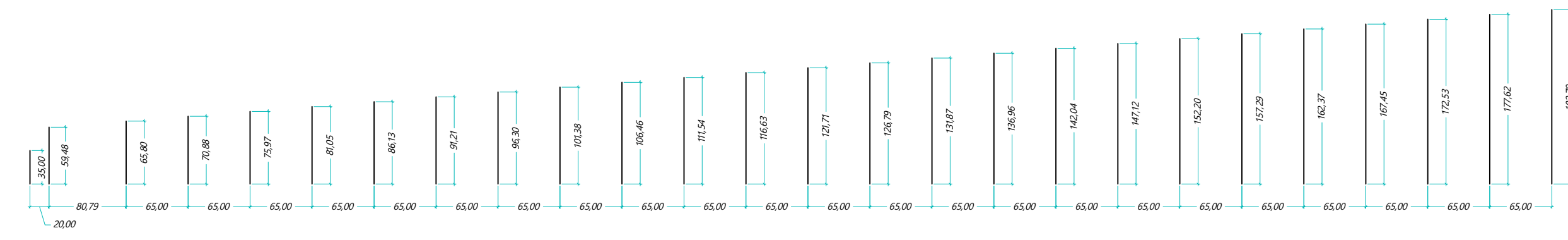

MONTANTE
PERFIL "U" SIMPLIS
127x40#14
3.25Kg/m

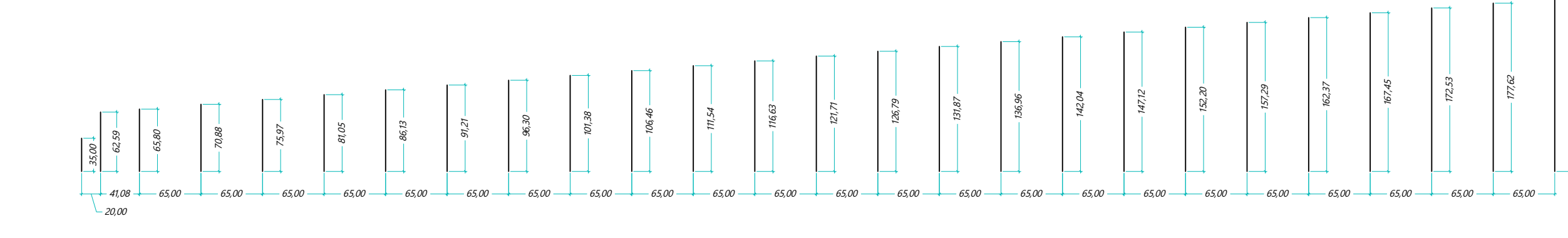

MONTANTE
PERFIL "U" SIMPLIS
127x40#14
3.25Kg/m



DIAGONAL
PERFIL "U" SIMPLIS
127x40#14
3.25Kg/m

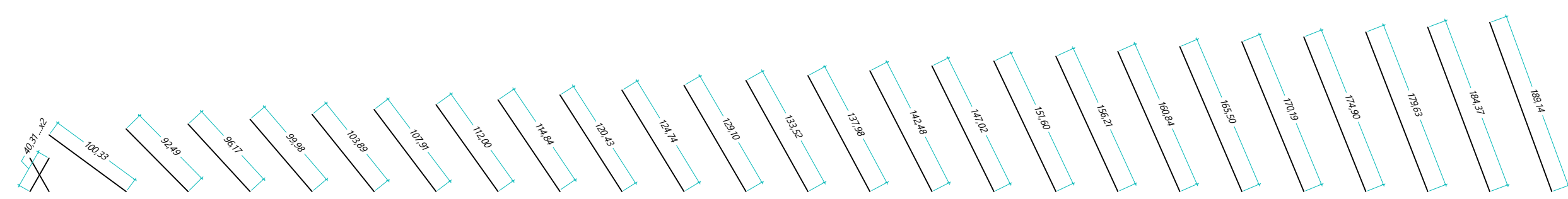

DIAGONAL
PERFIL "U" SIMPLIS
127x40#14
3.25Kg/m

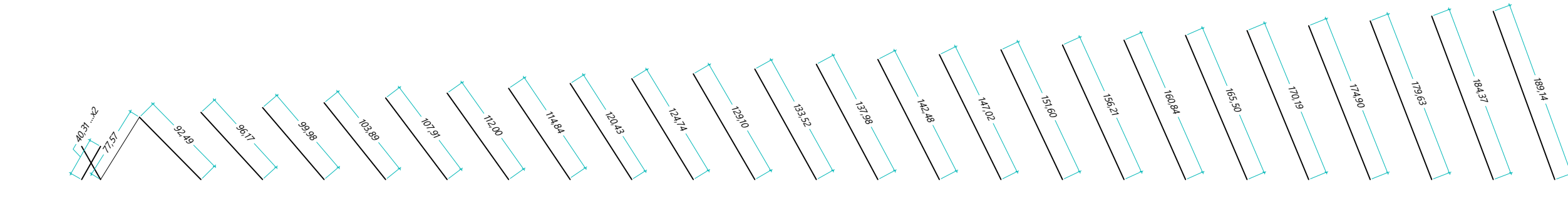

DIAGONAL
PERFIL "U" SIMPLIS
127x40#14
3.25Kg/m

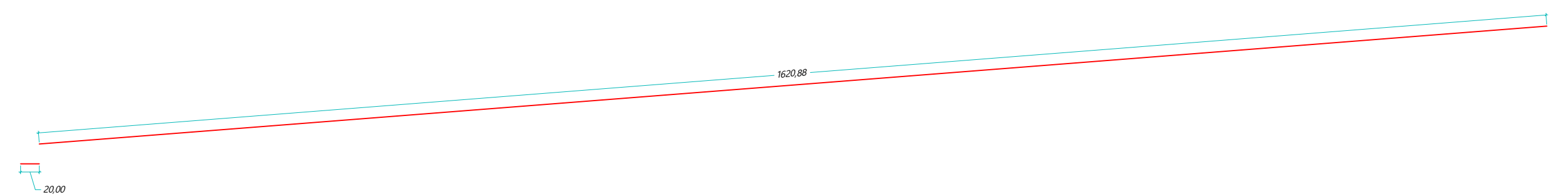

BANZO SUPERIOR E INFERIOR
PERFIL "U" SIMPLIS
150x50#13
4.42Kg/m

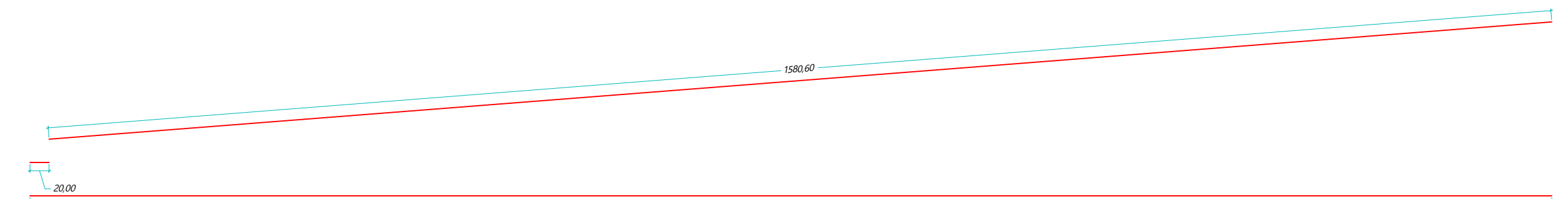

BANZO SUPERIOR E INFERIOR
PERFIL "U" SIMPLIS
150x50#13
4.42Kg/m

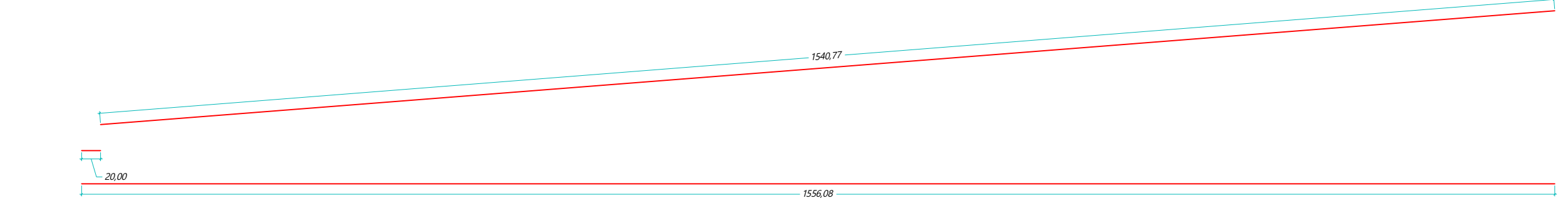

BANZO SUPERIOR E INFERIOR
PERFIL "U" SIMPLIS
150x50#13
4.42Kg/m

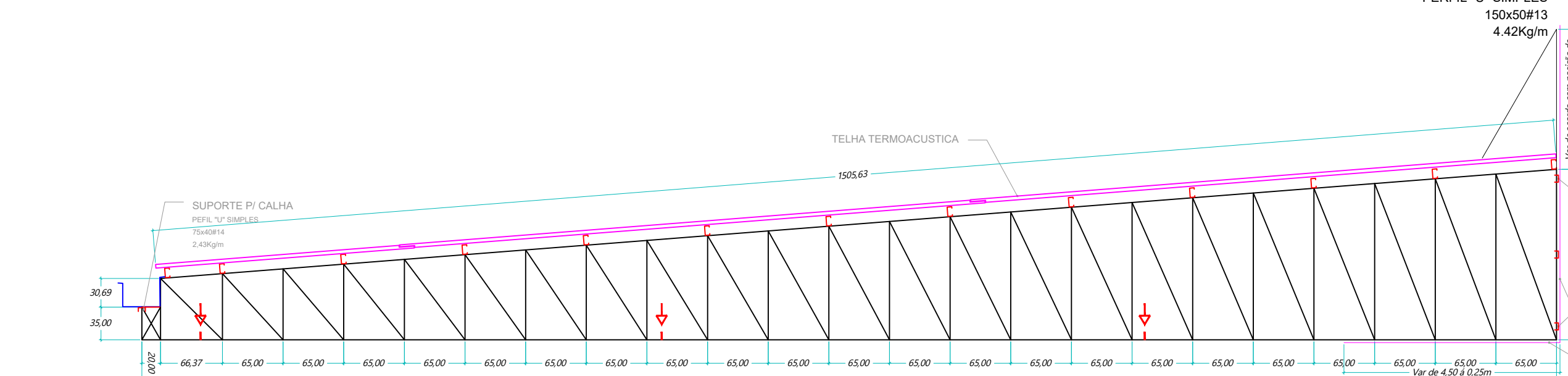

TESOURA 07
ESCALA 1:50

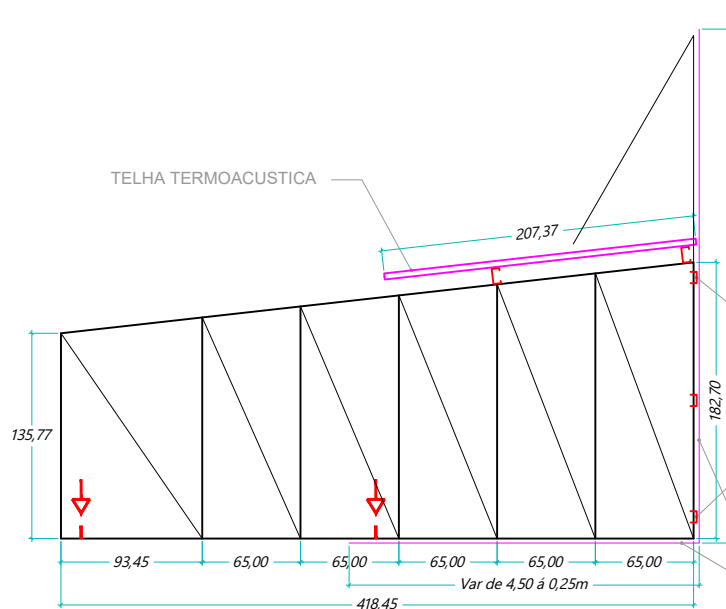

TESOURA 08
ESCALA 1:50

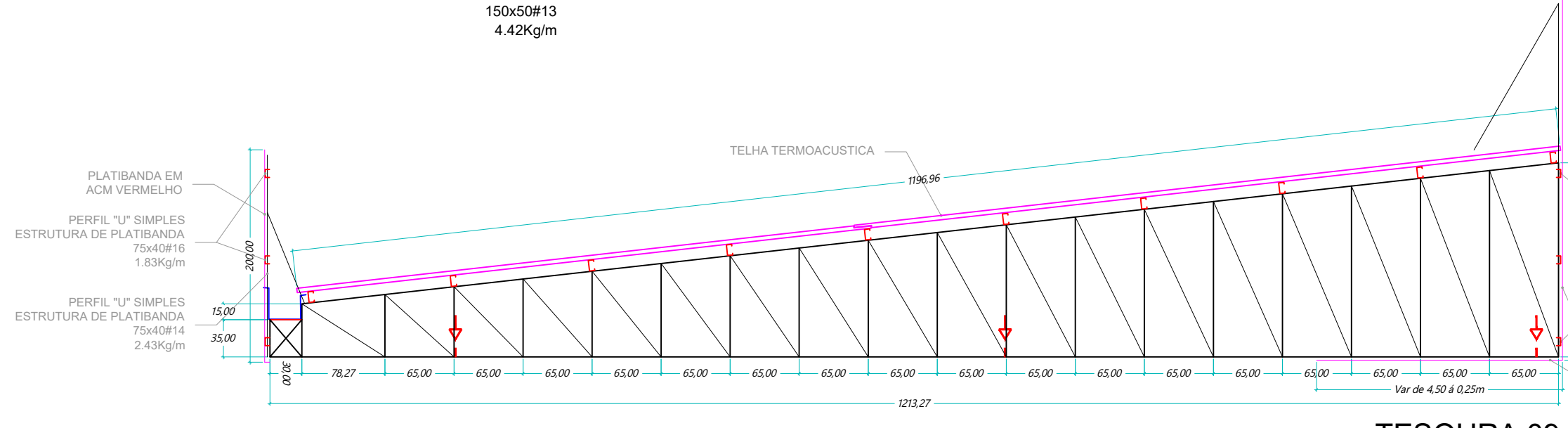

TESOURA 09
ESCALA 1:50

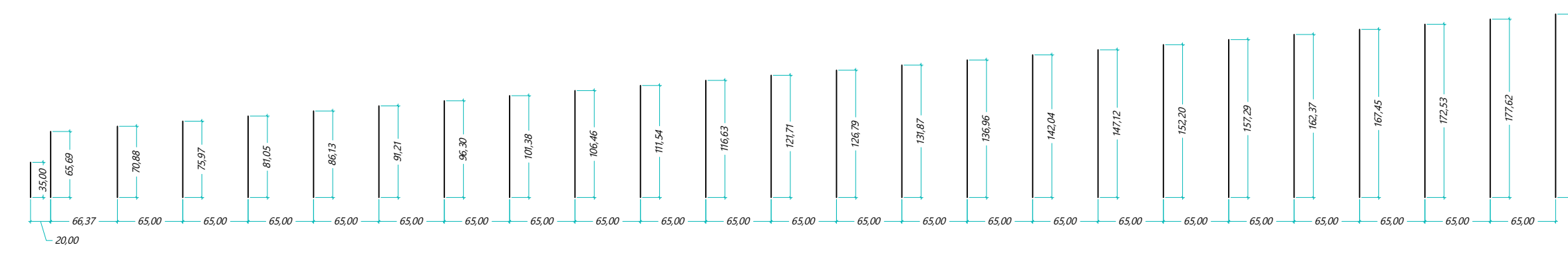

MONTANTE
PERFIL "U" SIMPLIS
127x40#14
3.25Kg/m

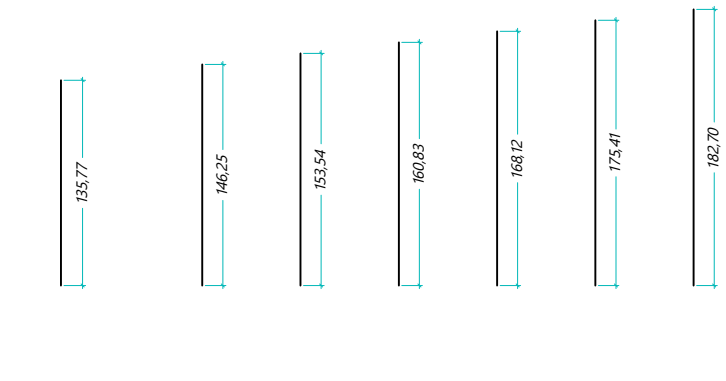

MONTANTE
PERFIL "U" SIMPLIS
127x40#14
3.25Kg/m

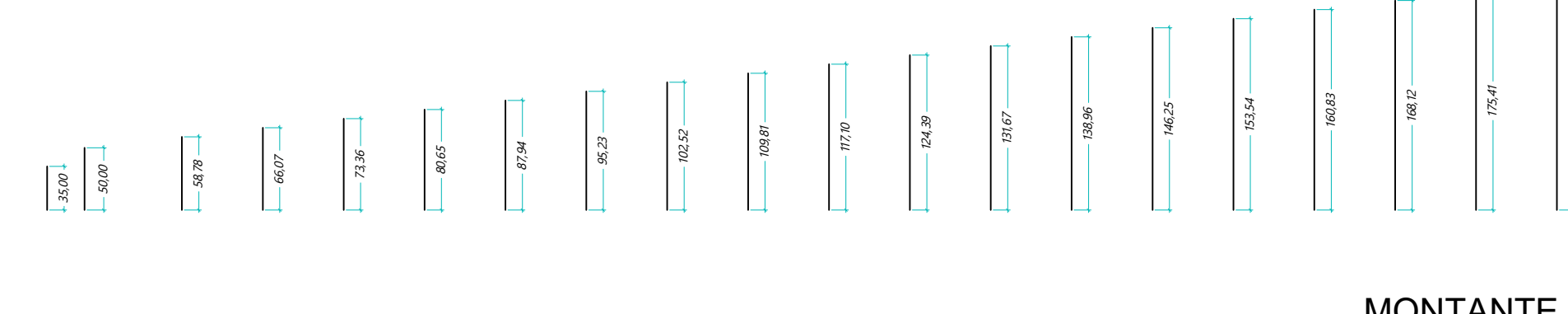

MONTANTE
PERFIL "U" SIMPLIS
127x40#14
3.25Kg/m



DIAGONAL
PERFIL "U" SIMPLIS
127x40#14
3.25Kg/m

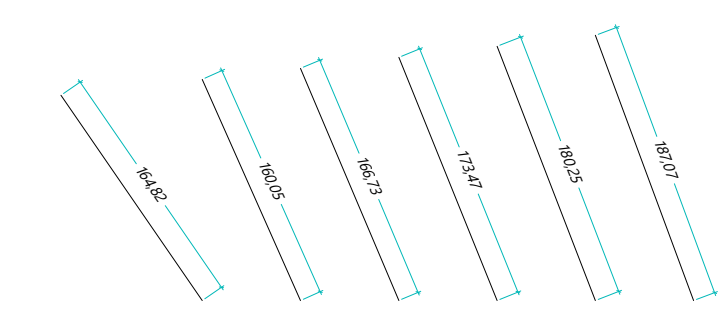

DIAGONAL
PERFIL "U" SIMPLIS
127x40#14
3.25Kg/m

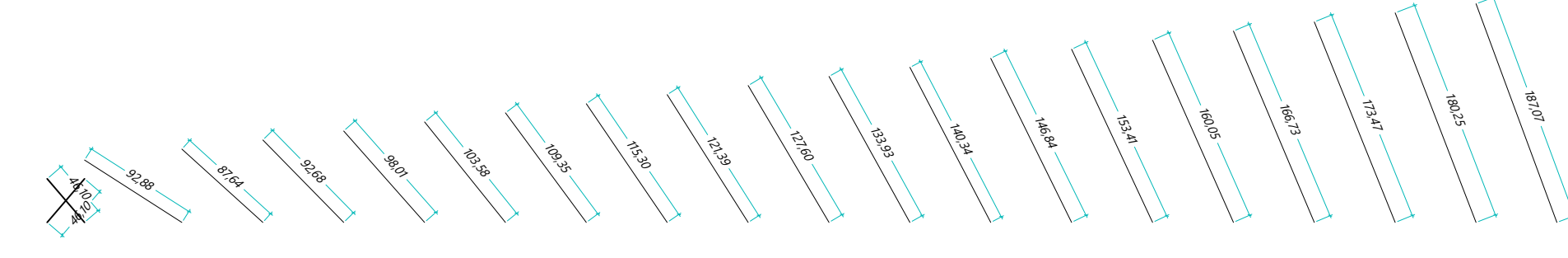

DIAGONAL
PERFIL "U" SIMPLIS
127x40#14
3.25Kg/m

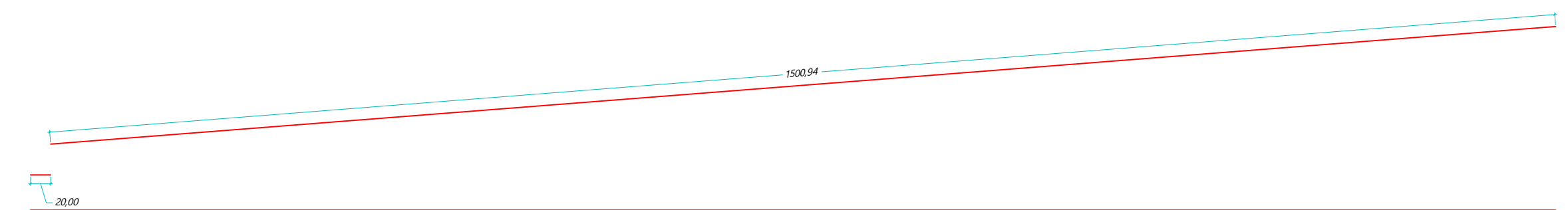

BANZO SUPERIOR E INFERIOR
PERFIL "U" SIMPLIS
150x50#13
4.42Kg/m

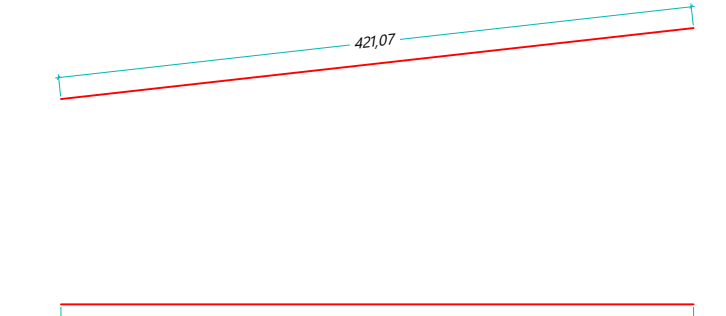

BANZO SUPERIOR E INFERIOR
PERFIL "U" SIMPLIS
150x50#13
4.42Kg/m

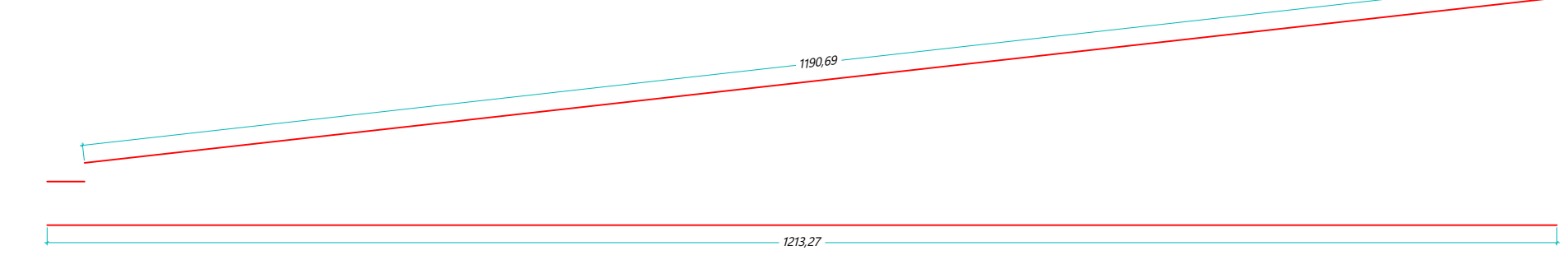

BANZO SUPERIOR E INFERIOR
PERFIL "U" SIMPLIS
150x50#13
4.42Kg/m

 GOVERNO DO ESTADO DE RONDÔNIA GOVERNO: Marcos José Rocha dos Santos	
 SECRETARIA DE ESTADO DA SEGURANÇA, DEFESA E CIDADANIA-SESEDEC	
OBJETO: CORPO DE BOMBEIROS MILITAR DE RONDONIA PROJ. ESTR. METÁLICA COMANDO GERAL DO CBMRO	
ENDERECO: AVENIDA GOVERNADOR JORGE TEIXEIRA S/N - INDUSTRIAL - PORTO VELHO - RO	LOCAL: PORTO VELHO - RO
CONTEUDO: PLANTA DE ESTR. METÁLICAS DE COBERTURA	DATA: 24/01/2025 PROCESSO: 0004.014091/2024-14
OBSERVAÇÕES TÉCNICAS: SUPERVISÃO DE PROJETOS JOSE CONSTANTINO DA SILVA JÚNIOR - CEL E ENL. MECÂNICO - CREIA 13.488/RO PROJETO	SETOR: XX QUADRA: XX LOTE: XX
AUTORIA DO PROJETO: JOSE CONSTANTINO DA SILVA JÚNIOR - CEL BM ENL. MECÂNICO - CREIA 13.488/RO RESPONSÁVEL TÉCNICO PELA OBRA	ESCALA: INDICADA DESENHO: EDUARDO HERRMANN - 1º SGT BM
ESTRUTURA METÁLICA	
ETAPA DE PROJETO: BÁSICO	
PRANCHA: 03	
QUADRO DE ÁREAS Área a Construir	3.005,91 m²
	
Observação:	
REV	MODIFICAÇÃO
01	DATA
02	PROJETISTA
03	CADISTA
APPROVO	
ESPAÇO PARA PREFEITURA E C.R.E.A.	